



ILLINOIS ENVIRONMENTAL PROTECTION AGENCY

1021 North Grand Avenue East, P.O. Box 19276, Springfield, Illinois 62794-9276 • (217) 782-2829
James R. Thompson Center, 100 West Randolph, Suite 11-300, Chicago, IL 60601 • (312) 814-6026

PAT QUINN, GOVERNOR

DOUGLAS P. SCOTT, DIRECTOR

RECEIVED
CLERK'S OFFICE

APR - 5 2012

STATE OF ILLINOIS
Pollution Control Board

RETURN TO CLERK'S OFFICE

(217) 782-9817
TDD: (217) 782-9143

April 3, 2012

John Therriault, Clerk
Illinois Pollution Control Board
James R. Thompson Center
100 West Randolph Street, Suite 11-500
Chicago, Illinois 60601

AC12-37

Re: Illinois Environmental Protection Agency v. William Bryant
IEPA File No. 67-12-AC; 0190855011—Champaign County

Dear Mr. Therriault:

Enclosed for filing with the Illinois Pollution Control Board, please find the original and nine true and correct copies of the Administrative Citation Package, consisting of the Administrative Citation, the inspector's Affidavit, and the inspector's Illinois Environmental Protection Agency Open Dump Inspection Checklist, issued to the above-referenced respondent(s).

On this date, a copy of the Administrative Citation Package was sent to the Respondent(s) via Certified Mail. As soon as I receive the return receipt, I will promptly file a copy with you, so that the Illinois Pollution Control Board may calculate the thirty-five (35) day appeal period for purposes of entering a default judgment in the event the Respondent(s) fails or elects not to file a petition for review contesting the Administrative Citation.

If you have any questions or concerns, please do not hesitate to contact me at the number above. Thank you for your cooperation.

Sincerely,

Michelle M. Ryan
Assistant Counsel

Enclosures

BEFORE THE ILLINOIS POLLUTION CONTROL BOARD
ADMINISTRATIVE CITATION

RECEIVED
CLERK'S OFFICE
APR - 5 2012
STATE OF ILLINOIS
Pollution Control Board

ILLINOIS ENVIRONMENTAL
PROTECTION AGENCY,

Complainant,

v.

WILLIAM BRYANT,

Respondent.

AC

(IEPA No. 67-12-AC)

12-37

NOTICE OF FILING

To: William Bryant
1010 County Road, 2125 E
Sidney, IL 61877-9752

PLEASE TAKE NOTICE that on this date I mailed for filing with the Clerk of the Pollution Control Board of the State of Illinois the following instrument(s) entitled ADMINISTRATIVE CITATION, AFFIDAVIT, and OPEN DUMP INSPECTION CHECKLIST.

Respectfully submitted,

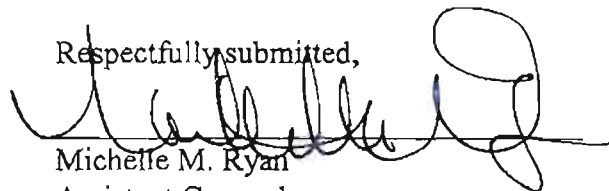

Michelle M. Ryan
Assistant Counsel

Illinois Environmental Protection Agency
1021 North Grand Avenue East
P.O. Box 19276
Springfield, Illinois 62794-9276
(217) 782-5544

Dated: April 3, 2012

BEFORE THE ILLINOIS POLLUTION CONTROL BOARD

ADMINISTRATIVE CITATION

RECEIVED
CLERK'S OFFICE
APR - 5 2012
STATE OF ILLINOIS
Pollution Control Board

ILLINOIS ENVIRONMENTAL)
PROTECTION AGENCY,)
)
Complainant,)
)
v.)
)
WILLIAM BRYANT,)
)
)
)
Respondent.)

AC 12-37
(IEPA No. 67-12-AC)

JURISDICTION

This Administrative Citation is issued pursuant to the authority vested in the Illinois Environmental Protection Agency by Section 31.1 of the Illinois Environmental Protection Act, 415 ILCS 5/31.1 (2010).

FACTS

1. That William Bryant is the current owner ("Respondent") of a facility located on 4.4 acres in the Northern Quarter of Section 15 Township 18 N Range 10 East in Sidney Township, Champaign County, Illinois. The property is commonly known to the Illinois Environmental Protection Agency as Sidney/B&T Bryant Trucking.
2. That said facility is an open dump operating without an Illinois Environmental Protection Agency Operating Permit and is designated with Site Code No. 0190855011.
3. That Respondent has owned said facility at all times pertinent hereto.
4. That on February 10, 2012, Jennifer O'Hearn of the Illinois Environmental Protection Agency's ("Illinois EPA") Champaign Regional Office inspected the above-described facility. A copy

of her inspection report setting forth the results of said inspection is attached hereto and made a part hereof.

5. That on 4-3-12, Illinois EPA sent this Administrative Citation via Certified Mail No. 7009 2820 0001 7496 0667.

VIOLATIONS

Based upon direct observations made by Jennifer O'Hearn during the course of her February 10, 2012 inspection of the above-named facility, the Illinois Environmental Protection Agency has determined that Respondent has violated the Illinois Environmental Protection Act (hereinafter, the "Act") as follows:

- (1) That Respondent caused or allowed the open dumping of waste in a manner resulting in litter, a violation of Section 21(p)(1) of the Act, 415 ILCS 5/21(p)(1) (2010).

- (2) That Respondent caused or allowed the open dumping of waste in a manner resulting in deposition of general construction or demolition debris; or clean construction or demolition debris, a violation of Section 21(p)(7) of the Act, 415 ILCS 5/21(p)(7) (2010).

CIVIL PENALTY

Pursuant to Section 42(b)(4-5) of the Act, 415 ILCS 5/42(b)(4-5) (2010), Respondent is subject to a civil penalty of One Thousand Five Hundred Dollars (\$1,500.00) for each of the violations identified above, for a total of Three Thousand Dollars (\$3,000.00). If Respondent elects not to petition the Illinois Pollution Control Board, the statutory civil penalty specified above shall be due and payable no later than April 30, 2012, unless otherwise provided by order of the Illinois

Pollution Control Board.

If Respondent elects to contest this Administrative Citation by petitioning the Illinois Pollution Control Board in accordance with Section 31.1 of the Act, 415 ILCS 5/31.1 (2010), and if the Illinois Pollution Control Board issues a finding of violation as alleged herein, after an adjudicatory hearing, Respondent shall be assessed the associated hearing costs incurred by the Illinois Environmental Protection Agency and the Illinois Pollution Control Board. Those hearing costs shall be assessed in addition to the One Thousand Five Hundred Dollar (\$1,500.00) statutory civil penalty for each violation.

Pursuant to Section 31.1(d)(1) of the Act, 415 ILCS 5/31.1(d)(1) (2010), if Respondent fails to petition or elects not to petition the Illinois Pollution Control Board for review of this Administrative Citation within thirty-five (35) days of the date of service, the Illinois Pollution Control Board shall adopt a final order, which shall include this Administrative Citation and findings of violation as alleged herein, and shall impose the statutory civil penalty specified above.

When payment is made, Respondent's check shall be made payable to the Illinois Environmental Protection Trust Fund and mailed to the attention of Fiscal Services, Illinois Environmental Protection Agency, 1021 North Grand Avenue East, P.O. Box 19276, Springfield, Illinois 62794-9276. Along with payment, Respondent shall complete and return the enclosed Remittance Form to ensure proper documentation of payment.

If any civil penalty and/or hearing costs are not paid within the time prescribed by order of the Illinois Pollution Control Board, interest on said penalty and/or hearing costs shall be assessed against the Respondent from the date payment is due up to and including the date that payment is received. The Office of the Illinois Attorney General may be requested to initiate proceedings against Respondent in Circuit Court to collect said penalty and/or hearing costs, plus any interest accrued.

PROCEDURE FOR CONTESTING THIS
ADMINISTRATIVE CITATION

Respondent has the right to contest this Administrative Citation pursuant to and in accordance with Section 31.1 of the Act, 415 ILCS 5/31/1 (2010). If Respondent elects to contest this Administrative Citation, then Respondent shall file a signed Petition for Review, including a Notice of Filing, Certificate of Service, and Notice of Appearance, with the Clerk of the Illinois Pollution Control Board, State of Illinois Center, 100 West Randolph, Suite 11-500, Chicago, Illinois 60601. A copy of said Petition for Review shall be filed with the Illinois Environmental Protection Agency's Division of Legal Counsel at 1021 North Grand Avenue East, P.O. Box 19276, Springfield, Illinois 62794-9276. Section 31.1 of the Act provides that any Petition for Review shall be filed within thirty-five (35) days of the date of service of this Administrative Citation or the Illinois Pollution Control Board shall enter a default judgment against the Respondent.



John J. Kim, Interim Director
Illinois Environmental Protection Agency

Date: 3/30/2012

Prepared by: Susan E. Konzelmann, Legal Assistant
Division of Legal Counsel
Illinois Environmental Protection Agency
1021 North Grand Avenue East
P.O. Box 19276
Springfield, Illinois 62794-9276
(217) 782-5544

RECEIVED
CLERK'S OFFICE
APR - 5 2012
STATE OF ILLINOIS
Pollution Control Board

REMITTANCE FORM

ILLINOIS ENVIRONMENTAL)
PROTECTION AGENCY,)
)
Complainant,)
)
v.)
)
WILLIAM BRYANT,)
)
)
)
Respondent.)

AC 12-37
(IEPA No. 67-12-AC)

FACILITY: Sidney/B&T Bryant Trucking
SITE CODE NO.: 0190855011
COUNTY: Champaign
CIVIL PENALTY: \$3,000.00
DATE OF INSPECTION: February 10, 2012

DATE REMITTED:

SS/FEIN NUMBER:

SIGNATURE:

NOTE

Please enter the date of your remittance, your Social Security number (SS) if an individual or Federal Employer Identification Number (FEIN) if a corporation, and sign this Remittance Form. Be sure your check is enclosed and mail, along with Remittance Form, to Illinois Environmental Protection Agency, Attn.: Fiscal Services, P.O. Box 19276, Springfield, Illinois 62794-9276.

ILLINOIS ENVIRONMENTAL PROTECTION AGENCY

AFFIDAVIT

IN THE MATTER OF:)
ILLINOIS ENVIRONMENTAL)
PROTECTION AGENCY,)
Complainant,)
)
)
William Bryant,)
Respondent,)

IEPA DOCKET NO.

AC12-37

RECEIVED
CLERK'S OFFICE
APR - 5 2012
STATE OF ILLINOIS
Pollution Control Board

Affiant, Jennifer O'Hearn, being first duly sworn, voluntarily deposes and states as follows:

1. Affiant is a field inspector employed by the Land Pollution Control Division of the Illinois Environmental Protection Agency and has been so employed at all times pertinent hereto.
2. On February 10, 2012, between 10:49 A.M. and 12:14 P.M., Affiant conducted an inspection of the site in Champaign County, Illinois, known as the B & T Bryant Trucking, Illinois Environmental Protection Agency Site No. 0190855011.
3. Affiant inspected said B & T Bryant Trucking site by an on-site inspection, which included walking the site.
4. As a result of the activities referred to in Paragraph 3 above, Affiant completed the Inspection Report form attached hereto and made a part hereof, which, to the best of Affiant's knowledge and belief, is an accurate representation of Affiant's observations and factual conclusions with respect to the B & T Bryant Trucking site, located at 2141 County Road 1000 N, Sidney, in Champaign County, Illinois site.

Jennifer O'Hearn
Jennifer O'Hearn

Subscribed and Sworn to before me
this 8th day of March,
2012.

Beverly Marie Carver
Notary Public



	(6)	Standing or Flowing Liquid Discharge from the Dump Site	<input type="checkbox"/>
--	-----	---	--------------------------

LPC # 0190855011

Inspection Date: 02/10/2012

	(7)	Deposition of: (i) General Construction or Demolition Debris as defined in Section 3.160(a); or (ii) Clean Construction or Demolition Debris as defined in Section 3.160(b)	<input checked="" type="checkbox"/>
9.	55(a)	NO PERSON SHALL:	
	(1)	Cause or Allow Open Dumping of Any Used or Waste Tire	<input type="checkbox"/>
	(2)	Cause or Allow Open Burning of Any Used or Waste Tire	<input type="checkbox"/>
10.	55(k)	NO PERSON SHALL:	
	(1)	Cause or Allow Water to Accumulate in Used or Waste Tires	<input checked="" type="checkbox"/>
	(4)	Transport Used or Waste Tires in Violation of the Registration and Placarding Requirements	<input type="checkbox"/>

**35 ILLINOIS ADMINISTRATIVE CODE REQUIREMENTS
SUBTITLE G**

11.	812.101(a)	FAILURE TO SUBMIT AN APPLICATION FOR A PERMIT TO DEVELOP AND OPERATE A LANDFILL	<input checked="" type="checkbox"/>
12.	722.111	HAZARDOUS WASTE DETERMINATION	<input type="checkbox"/>
13.	808.121	SPECIAL WASTE DETERMINATION	<input type="checkbox"/>
14.	809.302(a)	ACCEPTANCE OF SPECIAL WASTE FROM A WASTE TRANSPORTER WITHOUT A WASTE HAULING PERMIT, UNIFORM WASTE PROGRAM REGISTRATION AND PERMIT AND/OR MANIFEST	<input type="checkbox"/>
15.	815.201	FAILURE TO FILE AN INITIAL FACILITY REPORT WITH THE AGENCY TO PROVIDE INFORMATION CONCERNING LOCATION AND DISPOSAL PRACTICES OF THE FACILITY.	<input type="checkbox"/>

OTHER REQUIREMENTS

16.		APPARENT VIOLATION OF: (<input type="checkbox"/>) PCB; (<input type="checkbox"/>) CIRCUIT COURT CASE NUMBER: ORDER ENTERED ON:	<input type="checkbox"/>
17.	OTHER:		<input type="checkbox"/>
18.	55(a)	NO PERSON SHALL	<input type="checkbox"/>
	(3)	Except at a Tire Storage Site Which Contains More Than 50 Used Tires, Cause or Allow the Storage of Any Used Tire Unless the Tire is Altered, Reprocessed, Converted, Covered, or Otherwise Prevented from Accumulating Water.	<input checked="" type="checkbox"/>
			<input type="checkbox"/>
			<input type="checkbox"/>
			<input type="checkbox"/>

Informational Notes

1. [Illinois] Environmental Protection Act: 415 ILCS 5/4.
2. Illinois Pollution Control Board: 35 Ill. Adm. Code, Subtitle G.
3. Statutory and regulatory references herein are provided for convenience only and should not be construed as legal

conclusions of the Agency or as limiting the Agency's statutory or regulatory powers. Requirements of some statutes and regulations cited are in summary format. Full text of requirements can be found in references listed in 1. and 2. above.

4. The provisions of subsection (p) of Section 21 and subsection (k) of Section 55 of the [Illinois] Environmental Protection Act shall be enforceable either by administrative citation under Section 31.1 of the Act or by complaint under Section 31 of the Act.
5. This inspection was conducted in accordance with Sections 4(c) and 4(d) of the [Illinois] Environmental Protection Act: 415 ILCS 5/4(c) and (d).
6. Items marked with an "NE" were not evaluated at the time of this inspection.

Illinois Environmental Protection Agency
Bureau of Land ♦ Field Operations Section ♦ Champaign

019 085 5011 – Champaign County

Sidney/B & T Bryant Trucking

FOS

Inspector: Jennifer O’Hearn

Inspection Date: February 10, 2012

Complaint #: C12-015-CH

Open Dump Re-Inspection Narrative

Site History:

The original inspection of the site was conducted on August 10, 2011 by Jennifer O’Hearn. The site exhibited evidence of open dumping of waste including dimensional lumber, an upholstered cushion, metal, plastic toys, etc. and evidence of storage of waste on semi-trailers including dimensional lumber, a recliner, carpet, etc. The ACWN was sent on September 15, 2011 to B & T Bryant Trucking.

Champaign County Recorder’s and Assessor’s Office

I went to the Champaign County Supervisor of Assessments’ website. The property taxes were paid in the name of William Bryant at the mailing address of 1010 County Road 2125 E., Sidney, Illinois for the property located on 4.04 acres in the Northern Quarter of Section 15 Township 18 N Range 10 East in Sidney Township of Champaign County. The parcel for the property is #24-28-15-100-002.

General Comments:

Jennifer O’Hearn of DLPC/FOS Champaign Regional Office conducted a routine open dump inspection of the above referenced facility on February 10, 2012. This inspection was conducted to determine the regulatory status and evaluate compliance with the Environmental Protection Act (Act) and Title 35 Illinois Administrative Code, Subtitle G: Land Pollution (Regulations). The weather was cloudy, with the temperature around 35 degrees with 5-10 mph winds out of the southwest. Thirty-eight photos and no samples were taken; no one was present to represent the property owner.

The site is located about a quarter mile east of the village of Sidney limits on a commercial property located at 2141 County Road 1000 N. on the south side of the road. Most of the general waste piles are in the southwest portion of the site, with partially buried waste in the south central portion of the site, a pile of clay in the central portion of the site, piles of concrete and asphalt in the east portion of the site, tires in the southwest end and east end of the site, and trailers full of household waste on the west central portion of the site and east end of the site.

*019 085 5011 - Sidney/B & T Bryant Trucking
February 10, 2012 Inspection*

I arrived at the site at 10:49 A.M and parked north of the office. I walked up and knocked and no one answered. I then proceeded to walk to the southeast about fifty yards and saw a mattress, a comforter, dimensional lumber, metal, etc. on ground, and an excavator in view further away (photo 1). I turned slightly towards the north, still facing northwest, for a view of dimensional lumber, some painted dimensional lumber, plastic, etc. in with landscape waste, some waste in a pile, some waste along the lip of an apparent fill area (photo 2). I turned slightly further to the northeast now for a view of more waste including, dimensional lumber, foam rubber, plastic, metal, etc. along the lip of the fill area. Also in view was a pile of apparent treated telephone poles further away (photo 3). I stepped to the northwest about twenty-five yards and saw insulation, fiberboard, a lazy-boy recliner, dimensional lumber, general demolition debris, landscape waste, etc. and the mattress as in photo #1 from a view of the opposite side of the waste pile (photo 4). Next I walked around fifteen to twenty yards to the east for view of charred dimensional lumber, other charred material, aluminum siding, etc. on the ground and the low-lying area in between railroad tracks higher area of property (photos 5 & 6). I then walked several yards to the southeast and observed plastic toys and other plastic, a stuffed animal, dimensional lumber, etc. haphazardly scattered on ground (photo 7). Next, I walked a few yards to the northwest for a view of some of the waste in photo #7 along lip of fill edge, at border of higher and lower elevation of land. Sheet metal was also in view sitting on the lower elevation of land at the edge of the fill area (photo 8).

I then walked about a dozen yards to the southeast for a view of dimensional lumber, plywood, black plastic, etc. partially buried. Rusty sheet metal, metal pipe, etc. on other side of metal pile seen in photo #8 was also observed (photo 9). Then I walked to the southeast about twenty yards to see partially buried dimensional lumber and plywood (photo 10). Next I walked to the southeast twenty yards for a view of partially buried dimensional lumber and partially buried painted brick (photo 11). I then hiked to the northwest about fifteen yards to see partially buried dimensional lumber and corrugated black plastic pipe (photo 12). I walked to the south about a dozen yards to view of partially buried dimensional lumber (photo 13). I then walked to the southeast several yards and saw several pieces of partially buried dimensional lumber in front of soil pile (photo 14). I turned to the northeast and saw partially buried painted brick, dimensional lumber, etc. in front of the soil pile (photo 15). I stepped to the northeast ten yards and saw a metal chair leg protruding from ground and partially buried piece of rope (photo 16). I then stepped to the northeast several yards further and saw a partially buried piece of metal pipe (photo 17). Next I walked about ten yards still further to the northeast, entered my vehicle and proceeded to leave the site. (photo 18). I walked to the northeast a dozen yards and viewed rusty metal and plastic. (photo 19).

I then walked twenty yards to the northeast climbing over an asphalt pile and saw shingles, dimensional lumber, demolition debris, concrete block, etc. on top of asphalt pile (photo 20). I climbed several yards to the northeast and saw conduit with wiring, concrete with protruding rebar, etc. in with the concrete pile area (photo 21). I climbed along the concrete piles and

*019 085 5011 - Sidney/B & T Bryant Trucking
February 10, 2012 Inspection*

observed an open top trailer with waste visible inside (photo 22). Next I walked to the northwest for almost one hundred yards and saw three off rim tires partially covered in mud, plastic pipe partially buried in a soil pile, etc. (photo 23). I then trudged through the mud about a dozen yards to the southwest and saw a busted up plastic cooler, plywood, etc. on the ground (photo 24). I then stepped a couple yards to the southeast to view a plastic lawn chair and other plastic, rusty metal, dimensional lumber, plywood, etc. on the ground in a pile (photo 26).

After that I stepped a few yards to the northwest for views of the tops of open top trailers with waste including plastic, a mattress, metal, etc. Pallets, dimensional lumber, and three tires were on the ground nearby (photos 27, 28 & 29). Subsequently, I walked forty-five to fifty yards to the southwest and observed water in the form of ice in an off rim tire on the ground (photo 30). Next I walked about ten yards for a view of off rim tires (photo 31). I then walked several yards to the northwest for a view of on rim tires (photo 32). Next I stepped to the northeast several yards and observed two off rim tires with water in the form of ice inside (photo 33). I then walked to the east a couple yards and viewed more off rim tires (photo 34). I then walked forty yards back to my vehicle, stepped in my vehicle and drove to the eastern entrance to the site about seventy-five yards to the east of the western entrance, pulled in and parked. I then exited my vehicle, and walked along County Road 1000 N to the east about 70 yards and then south about 70 yards to view off rim tires in an open topped trailer not covered to prevent accumulation of water (photo 35). I turned and looked to the northwest and saw water in the form of ice in a tire with other tires on the ground behind the trailer (photo 36). I returned 75 yards to the northwest and then viewed the open top trailer with waste including a box springs, metal, plastic, etc. as seen in photo #22 (photo 37). I turned to the southwest for a view of the concrete and asphalt piles (photo 38). I walked about seventy yards to the southwest, entered my vehicle and proceeded to leave the site. I left the site at 12:14 P.M.

In summary, if any waste has left the site since the previous inspection, more waste has been brought in to take its place. None of the five trailers that were full of waste have been emptied and many of the trailers have waste visible that is the same as in the previous inspection. The amount of waste piled up around the site appears to have increased from about 40 cubic yards to 60 cubic yards. Around 20 cubic yards of tires that were not included in the previous inspection were observed at this site in this inspection. Many tires were observed to hold water in the form of ice.

Interview-Bill Bryant, owner of B & T Trucking and property

I called 217/688-3022, the business phone number for B & T Bryant Trucking, on February 27, 2012 and after several attempts in redialing with and without the area code and with and without dialing 1 and receiving the same message that "we're sorry your call can not be completed as dialed", I determined that the number had been disconnected.

019 085 5011 - Sidney/B & T Bryant Trucking
February 10, 2012 Inspection

Then that same morning I called 217/688-2968, the home phone number listed for Bill Bryant, 1010 CR 2125 E, Sidney, Illinois and received an answering machine. I left a message indicating my phone number and my name, and that I was calling from the Illinois EPA and requesting that Mr. Bryant call me so that we could discuss his property located at 2141 CR 1000N, Sidney, Illinois where I conducted an inspection. I have not yet received a call.

Apparent violations observed during this inspection:

Upon reinspection of the site on February 10, 2012, outstanding violations included:

Environmental Protection Act. 415 ILCS 5/1 et. seq. (formerly Ill. Rev. Stat. Ch. 111 1/2, 1001 et. seq.) {hereinafter called the "Act"}

#1 Pursuant to Section 21(a) of the Act, no person shall cause or allow the open dumping of any waste.

A violation of Section 21(a) is alleged for the following reason: **evidence of open dumping of waste was observed during the inspection.**

#2 Pursuant to Section 21(d)(1) of the Act, no person shall conduct any waste-storage, waste-treatment, or waste-disposal operation without a permit

A violation of Section 21(d)(1) is alleged for the following reason: **evidence of the operation of a waste-storage, waste-treatment, or waste-disposal operation without a permit was observed during the inspection.**

#3 Pursuant to Section 21(d)(2) of the Act, no person shall conduct any waste-storage, waste-treatment, or waste-disposal operation in violation of any regulations or standards adopted by the Pollution Control Board.

A violation of Section 21(d)(2) is alleged for the following reason: **evidence of the operation of a waste-storage, waste-treatment, or waste-disposal operation in violation of regulations adopted by the Board was observed during the inspection.**

#4 Pursuant to Section 21(e) of the Act, no person shall dispose, treat, store or abandon any waste or transport any waste into this State for disposal, treatment, storage, or abandonment, except at a site or facility which meets the requirements of this Act and of regulations and standards thereunder.

A violation of Section 21(e) is alleged for the following reason: **waste was stored and/or disposed of at this site which does not meet the requirements of the Act and**

of regulations and standards thereunder.

- #5 Pursuant to Section 21(p)(1) of the Act, no one shall cause or allow the open dumping of any waste in a manner which results in litter.

A violation of Section 21(p)(1) is alleged for the following reason: **waste was open dumped at this site resulting in litter.**

- #6 Pursuant to Section 21(p)(7) of the Act, no one shall cause or allow the open dumping of any waste in a manner which results in deposition of general construction or demolition debris.

A violation of Section 21(p)(7) is alleged for the following reason: **waste was open dumped at this site resulting in deposition of general construction and demolition debris.**

35 Illinois Administrative Code. (Title 35: Environmental Protection, Subtitle G: Land Pollution, Chapter I: Pollution Control Board) [Regulations]

- #7 Pursuant to Section 812.101(a) of the Regulations, All persons, except those specifically exempted by Section 21(d) of the Act, shall submit to the Agency an application for a permit to develop and operate a landfill.

A violation of Section 812.101(a) is alleged for the following reason: **this waste management site has not submitted an application to the Agency for a permit to develop and operate a landfill.**

Newly observed violations:

Upon reinspection of the site on February 10, 2012, the following new violations were observed:

Environmental Protection Act. 415 ILCS 5/1 et. seq. (formerly Ill. Rev. Stat. Ch. 111 1/2, 1001 et. seq.) {hereinafter called the "Act"}

- #8 Pursuant to Section 55(a)(3) of the [Illinois] Environmental Protection Act (415 ILCS 5/55(a)(3)), no person shall except at a tire storage site which contains more than 50 used tires, cause or allow the storage of any used tire unless the tire is altered, reprocessed, converted, covered, or otherwise prevented from accumulating water.

A violation of Section 55(a)(3) of the Act (415 ILCS 5/55(a)(3)) is alleged for the

019 085 5011 - Sidney/B & T Bryant Trucking
February 10, 2012 Inspection

following reason: **Water in the form of ice was observed in used tires during this inspection.**

#9 Pursuant to Section 55(k)(1) of the [Illinois] Environmental Protection Act (415 ILCS 5/55(k)(1)), no person shall cause or allow water to accumulate in used or waste tires.

A violation of Section 55(k)(1) of the Act (415 ILCS 5/55(a)(3)) is alleged for the following reason: **Water in the form of ice was observed in used or waste tires during this inspection.**

STATE OF ILLINOIS
ENVIRONMENTAL PROTECTION AGENCY
SITE SKETCH

Date of Inspection : 02/10/12 County: Champaign City: Sidney
Inspector: Jennifer O'Hearn
Site Name : Sidney/B & T Bryant Trucking
Site Code: 0190855011

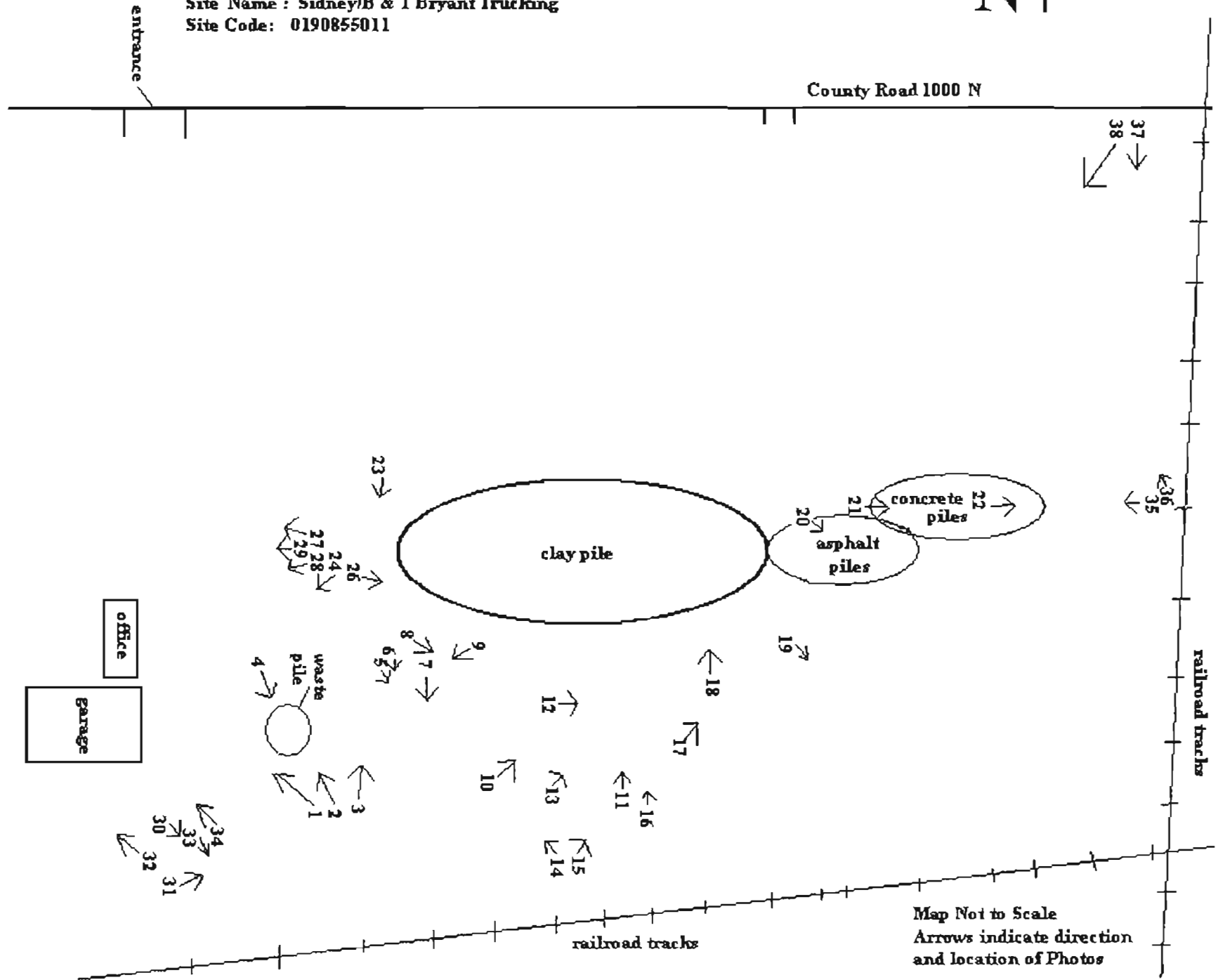

Map Not to Scale
Arrows indicate direction
and location of Photos



DIGITAL PHOTOGRAPHS File Names: 0190855011~02102012-[Exp. #].jpg

Date:02-10-2012
Time: 10:57AM
Direction: Northwest
Photo by: Jen
O'Hearn
Exposure #: 001
Comments: View of
mattress,
comforter,
dimensional
lumber, metal, etc.
on ground, an
excavator in view
further away.



Date:02-10-2012
Time: 10:58AM
Direction: Northwest
Photo by: Jen
O'Hearn
Exposure #: 002
Comments: View of
dimensional
lumber, some
painted
dimensional
lumber, plastic,
etc. in with
landscape waste,
some in pile, some
along lip of
apparent fill area.





DIGITAL PHOTOGRAPHS File Names: 0190855011~02102012-[Exp. #].jpg



Date:02-10-2012
Time: 10:59AM
Direction: Northeast
Photo by: Jen O'Hearn
Exposure #: 003
Comments: View of more waste including, dimensional lumber, foam rubber, plastic, metal, etc. along lip of fill area. View of pile of apparent treated telephone poles further away.



Date:02-10-2012
Time: 11:04AM
Direction: Southeast
Photo by: Jen O'Hearn
Exposure #: 004
Comments: View of insulation, fiberboard, lazy-boy recliner, dimensional lumber, general demolition debris, landscape waste, etc.; mattress as in photo #1 from view of opposite side of waste pile.



DIGITAL PHOTOGRAPHS File Names: 0190855011~02102012-[Exp. #].jpg



Date:02-10-2012
Time: 11:05AM
Direction: Southeast
Photo by: Jen
O'Hearn
Exposure #: 005
Comments: View of
charred
dimensional
lumber, other
charred material,
aluminum siding,
etc. on ground.



Date:02-10-2012
Time: 11:06AM
Direction: South
Photo by: Jen
O'Hearn
Exposure #: 006
Comments: View of
dimensional
lumber, aluminum
siding, low-lying
area in between
railroad tracks
higher area of
property.



DIGITAL PHOTOGRAPHS File Names: 0190855011-02102012-[Exp. #].jpg



Date:02-10-2012
Time: 11:06AM
Direction: South
Photo by: Jen O'Hearn
Exposure #: 007
Comments: View of plastic toys and other plastic, a stuffed animal, dimensional lumber, etc. haphazardly scattered on ground.



Date:02-10-2012
Time: 11:08AM
Direction: Southeast
Photo by: Jen O'Hearn
Exposure #: 008
Comments: View of some of waste in photo #7 along lip of fill edge, at border of higher and lower elevation of land. View of sheet metal sitting on lower elevation of land at edge of fill area.



DIGITAL PHOTOGRAPHS File Names: 0190855011-02102012-[Exp. #].jpg



Date:02-10-2012
Time: 11:09AM
Direction: Southwest
Photo by: Jen O'Hearn
Exposure #: 009
Comments: View of dimensional lumber, plywood, black plastic, etc. partially buried. Rusty sheet metal, metal pipe, etc. on other side of metal pile seen in photo #8.



Date:02-10-2012
Time: 11:11AM
Direction: Northeast
Photo by: Jen O'Hearn
Exposure #: 010
Comments: View of partially buried dimensional lumber and plywood.



DIGITAL PHOTOGRAPHS File Names: 0190855011~02102012-[Exp. #].jpg



Date:02-10-2012
Time: 11:13AM
Direction: North
Photo by: Jen O'Hearn
Exposure #: 011
Comments: View of partially buried dimensional lumber and partially buried painted brick.



Date:02-10-2012
Time: 11:15AM
Direction: East
Photo by: Jen O'Hearn
Exposure #: 012
Comments: View of partially buried dimensional lumber and corrugated black plastic pipe.



DIGITAL PHOTOGRAPHS File Names: 0190855011-02102012-[Exp. #].jpg



Date:02-10-2012
Time: 11:17AM
Direction: Northeast
Photo by: Jen
O'Hearn
Exposure #: 013
Comments: View of
partially buried
dimensional
lumber.



Date:02-10-2012
Time: 11:18AM
Direction: Northwest
Photo by: Jen
O'Hearn
Exposure #: 014
Comments: View of
several pieces of
partially buried
dimensional
lumber in front of
soil pile.



DIGITAL PHOTOGRAPHS File Names: 0190855011~02102012-[Exp. #].jpg



Date:02-10-2012
Time: 11:18AM
Direction: Northeast
Photo by: Jen
O'Hearn
Exposure #: 015
Comments: View of
partially buried
painted brick,
dimensional
lumber, etc. in
front of soil pile.



Date:02-10-2012
Time: 11:19AM
Direction: North
Photo by: Jen
O'Hearn
Exposure #: 016
Comments: View of
metal chair leg
protruding from
ground and
partially buried
piece of rope.



DIGITAL PHOTOGRAPHS File Names: 0190855011-02102012-[Exp. #].jpg



Date:02-10-2012
Time: 11:19AM
Direction: Northeast
Photo by: Jen
O'Hearn
Exposure #: 017
Comments: View of
partially buried
piece of metal
pipe.



Date:02-10-2012
Time: 11:20AM
Direction: North
Photo by: Jen
O'Hearn
Exposure #: 018
Comments: View of
rusty metal and
waste plastic
corrugated pipe.



DIGITAL PHOTOGRAPHS File Names: 0190855011-02102012-[Exp. #].jpg



Date:02-10-2012
Time: 11:21AM
Direction: Southeast
Photo by: Jen
O'Hearn
Exposure #: 019
Comments: View of
rusty metal and
plastic.



Date:02-10-2012
Time: 11:23AM
Direction: Southeast
Photo by: Jen
O'Hearn
Exposure #: 020
Comments: View of
shingles,
dimensional
lumber, demolition
debris, concrete
block, etc. on top
of asphalt pile.



DIGITAL PHOTOGRAPHS File Names: 0190855011~02102012-[Exp. #].jpg



Date:02-10-2012
Time: 11:24AM
Direction: East
Photo by: Jen O'Hearn
Exposure #: 021
Comments: View of conduit with wiring, concrete with protruding rebar, etc.



Date:02-10-2012
Time: 11:28AM
Direction: Northeast
Photo by: Jen O'Hearn
Exposure #: 022
Comments: View of open top trailer with waste visible inside.



DIGITAL PHOTOGRAPHS File Names: 0190855011-02102012-[Exp. #].jpg



Date:02-10-2012
Time: 11:34AM
Direction: Southwest
Photo by: Jen
O'Hearn
Exposure #: 023
Comments: View of
three off rim tires
partially covered in
mud, plastic pipe
partially buried in
soil pile.



Date:02-10-2012
Time: 11:38AM
Direction: Southwest
Photo by: Jen
O'Hearn
Exposure #: 024
Comments: View of
busted up plastic
cooler, plywood,
etc. on ground.



DIGITAL PHOTOGRAPHS File Names: 0190855011~02102012-[Exp. #].jpg



Date:02-10-2012
Time: 11:38AM
Direction: ?
Photo by: Jen
O'Hearn
Exposure #: 025
Comments: Bad
photo from
bumping camera.



Date:02-10-2012
Time: 11:38AM
Direction: Southeast
Photo by: Jen
O'Hearn
Exposure #: 026
Comments: View of
plastic lawn chair
and other plastic,
rusty metal,
dimensional
lumber, plywood,
etc. on ground in
pile.



DIGITAL PHOTOGRAPHS File Names: 0190855011~02102012-[Exp. #].jpg



Date:02-10-2012
Time: 11:41AM
Direction: Northwest
Photo by: Jen
O'Hearn
Exposure #: 027
Comments: View of
tops of open top
trailers with waste
including plastic, a
mattress, etc.



Date:02-10-2012
Time: 11:41AM
Direction: Southwest
Photo by: Jen
O'Hearn
Exposure #: 028
Comments: View of
tops of open top
trailers with waste
including plastic,
metal, etc. two
trailers on right as
seen in photo #27.



DIGITAL PHOTOGRAPHS File Names: 0190855011~02102012-[Exp. #].jpg



Date:02-10-2012
Time: 11:42AM
Direction: West
Photo by: Jen
O'Hearn
Exposure #: 029
Comments: Another
view of trailers in
photos #27 & 28.
Pallets,
dimensional
lumber, and three
tires on ground
nearby.



Date:02-10-2012
Time: 11:45AM
Direction: Southeast
Photo by: Jen
O'Hearn
Exposure #: 030
Comments: View of
water in the form
of ice in an off rim
tire on ground.



DIGITAL PHOTOGRAPHS File Names: 0190855011~02102012-[Exp. #].jpg

Date:02-10-2012
Time: 11:46AM
Direction: Northeast
Photo by: Jen
O'Hearn
Exposure #: 031
Comments: View of
off rim tires.



Date:02-10-2012
Time: 11:46AM
Direction: Northwest
Photo by: Jen
O'Hearn
Exposure #: 032
Comments: View of
on rim tires.





DIGITAL PHOTOGRAPHS File Names: 0190855011~02102012-[Exp. #].jpg



Date:02-10-2012
Time: 11:47AM
Direction: Southeast
Photo by: Jen
O'Hearn
Exposure #: 033
Comments: View of
two off rim tires
with ice inside.



Date:02-10-2012
Time: 11:49AM
Direction: Northwest
Photo by: Jen
O'Hearn
Exposure #: 034
Comments: View of
more off rim tires.



DIGITAL PHOTOGRAPHS File Names: 0190855011~02102012-[Exp. #].jpg



Date:02-10-2012
Time: 12:05PM
Direction: West
Photo by: Jen O'Hearn
Exposure #: 035
Comments: View of off rim tires in open topped trailer not prevented from accumulating water.



Date:02-10-2012
Time: 12:06PM
Direction: Northwest
Photo by: Jen O'Hearn
Exposure #: 036
Comments: View of water in the form of ice in tire with other tires on ground behind trailer.



DIGITAL PHOTOGRAPHS File Names: 0190855011-02102012-[Exp. #].jpg



Date:02-10-2012
Time: 12:09PM
Direction: South
Photo by: Jen
O'Hearn
Exposure #: 037
Comments: View of
open top trailer
with waste
including a box
springs, metal,
plastic, etc. as in
photo #22.



Date:02-10-2012
Time: 12:11PM
Direction: Southwest
Photo by: Jen
O'Hearn
Exposure #: 038
Comments: View of
concrete and
asphalt piles.

WWW.CYBERDRIVEILLINOIS.COM

JESSE WHITE
SECRETARY OF STATE



CORPORATION FILE DETAIL REPORT

Entity Name	B & T BRYANT TRUCKING, INC.	Entity Number	62399686
Status	DISSOLVED		
Entity Type	CORPORATION	Type of Corp.	DOMESTIC BCA
Incorporation Date (Domestic)	09/04/2002		ILLINOIS
Agent Name	** AGENT VACATED **	Agent Change Date	11/11/2011
Agent Street Address		Principal Name & Address	WILLIAM F BRYANT 1010 CR 2125 E SIDNEY 61877
Agent City		Expiration Date & Condition	INVOLUNTARY DISSOLUTION 02 11 12
Agent Zip		Duration Date	PERPETUAL
Annual Report Filing Date	00/00/0000	Doc Year	2011

[Return to the Search Screen](#)

BACK TO CYBERDRIVEILLINOIS.COM HOME PAGE

LPC #: 019085 5011

SITE NAME: Sidney LBT Bryant Trucking

Champaign County Assessor Information

- Select by Perm Number
- Select by Prop loc
- Select Assessment by Township
- Select Sales by Township

[Click here for GIS parcel map](#)

Previous Screen

Taxpayer and Parcel Information		Township	
Name	BRYANT WILLIAM	Assessor:	WILLARD JAMIE 688-2841
Mailing Address	1010 COUNTY ROAD 2125 E	Pin:	24-28-15-100-002
	STONEY IL 61877-9752	Sect Twp Prop code	Range Acres
Property Location	2141 1000N	15 18 3000	10 4.04
Taxpayer Description		Latest Deed Reference	
		Bk: Pg: Docno: 2003R0502B	

Brief Legal Description	Sales Information		
	Mo/Yr	Amount	Type
	3 1985	\$27,519	Single Parcel
	7 1999	\$34,000	Single Parcel
	11 2001	\$40,000	Single Parcel
	1 2003	\$45,000	Single Parcel



Assessment Records						
		Land	Building	Farm Land	Farm Building	Total
2011 Pay 2012	FINAL	\$12,650.	\$4,230.	\$0.	\$0.	\$16,880.
2010 Pay 2011	FINAL	\$12,650.	\$4,230.	\$0.	\$0.	\$16,880.
2009 Pay 2010	FINAL	\$12,650.	\$4,230.	\$0.	\$0.	\$16,880.
2008 Pay 2009	FINAL	\$12,460.	\$4,170.	\$0.	\$0.	\$16,630.
2007 Pay 2008	FINAL	\$12,140.	\$4,060.	\$0.	\$0.	\$16,200.

Appeal Assessments between July 1st and Sept 10th at Board of Review 384-3758.

Exemptions Records						Annual Drainage	Special Drainage
		Owner Occupied	Home Improvements	All Others	Total	Amount	Paid In Amount
2010 Pay 2011	FINAL	\$0.	\$0.	\$0.	\$0.	\$0.00	2011 \$0.00
2009 Pay 2010	FINAL	\$0.	\$0.	\$0.	\$0.	\$0.00	2010 \$0.00
2008 Pay 2009	FINAL	\$0.	\$0.	\$0.	\$0.	\$0.00	2009 \$0.00
2007 Pay 2008	FINAL	\$0.	\$0.	\$0.	\$0.	\$0.00	2008 \$0.00
2006 Pay 2007	FINAL	\$0.	\$0.	\$0.	\$0.	\$0.00	2007 \$0.00

Bill E Bryant

LPC#09085 SD11 SITE NAME

Sidney / B+T Bryant Trucking

(217) 688-2968

1010 County Road 2125 E

Sidney, IL 61877-9752

Age: 50-54

Associated: Terri J Bryant



[Claim It!](#) »

Are you Bill? Edit your Info. Connect with your neighbors.

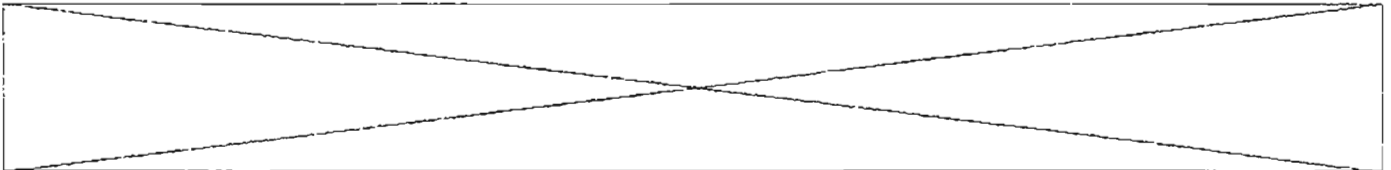
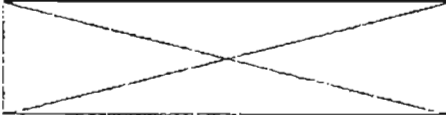
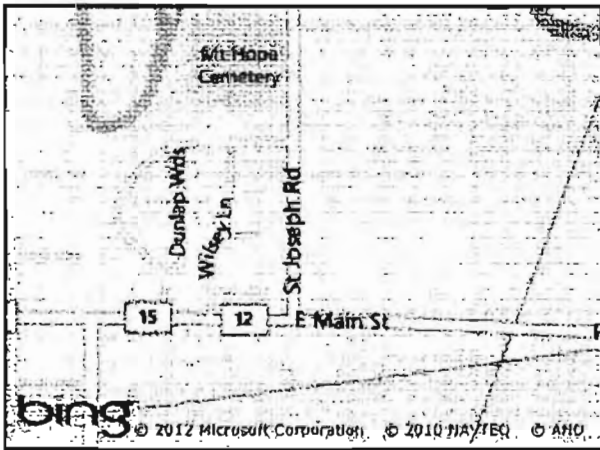

Champaign County Assessor Information

LPC#0190855011

*SITE: Sidney/B+T Bryant
NAME: Trucking*

- Select by Perm Number
- Select by Prop loc
- Select Assessment by Township
- Select Sales by Township

Click here for GIS parcel map

Previous Screen

Taxpayer and Parcel Information		Township Assessor: WILLARD JAMIE 888-2841	
Name	BIALESCHKI TERRI	Pin:	24-28-10-376-005
Mailing Address	1010 COUNTY ROAD 2125 E	Sect Twp Prop code	Range Acres
	SIDNEY IL 61877-9752	10 18 1150	10 50
Property Location	101B 2125E	Latest Deed Reference	
Taxpayer Description		Bk: 2448 Pg: 470 Docno:	

Brief Legal Description	Sales Information		
N132° S537.18' W165° E1/2 SW 10-18-10	mo/yr	Amount	Type
	9 1996	\$35,620	Single Parcel
			Acres
			.50



Assessment Records						
		Land	Building	Farm Land	Farm Building	Total
2011 Pay 2012	FINAL	\$5,600	\$44,700	\$0	\$0	\$50,300
2010 Pay 2011	FINAL	\$5,600	\$44,700	\$0	\$0	\$50,300
2009 Pay 2010	FINAL	\$5,600	\$44,700	\$0	\$0	\$50,300
2008 Pay 2009	FINAL	\$5,520	\$44,040	\$0	\$0	\$49,560
2007 Pay 2008	FINAL	\$5,380	\$42,920	\$0	\$0	\$48,300
Market Value		\$5,600	\$44,700	\$0	\$0	\$50,300

Appeal Assessments between July 1st and Sept 10th at Board of Review 384-3758.

Exemptions Records					Annual Drainage	Special Drainage
	Owner Occupied	Home Improvements	All Others	Total	Amount	Paid in Amount
2010 Pay 2011	FINAL	\$6,000	\$0	\$0	\$6,000	2011 \$0.00
2009 Pay 2010	FINAL	\$6,000	\$0	\$0	\$6,000	2010 \$0.00
2008 Pay 2009	FINAL	\$5,500	\$0	\$0	\$5,500	2009 \$0.00
2007 Pay 2008	FINAL	\$5,000	\$0	\$0	\$5,000	2008 \$0.00
2006 Pay 2007	FINAL	\$5,000	\$0	\$0	\$5,000	2007 \$0.00

5/23

WARRANTY DEED

8/2009

2003R05028

RECORDED ON

01-30-2003 4:06:25

CHAMPAIGN COUNTY
RECORDER
BARBARA A. FRASCA

REC. FEE: 25.00
REV FEE: 67.50
PAGES: 3
PLAT ACT: 2
PLAT PAGE:

THE GRANTOR, SPORT REDI-MIX, LLC, an Illinois Limited Liability Company, of the City of Champaign, in the County of Champaign, and State of Illinois, for and in consideration of Ten Dollars (\$10.00), and other good and valuable consideration in hand paid, CONVEY and WARRANT to the GRANTEE, WILLIAM BRYANT, of the Village of Sidney, in the County of Champaign, and State of Illinois, the following described real estate:

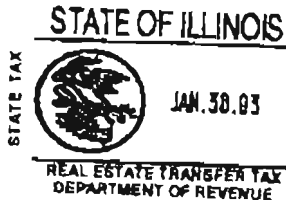

REAL ESTATE TRANSFER TAX
0004500
FP 102811

0000006495

Champaign County
Real Estate Transfer Tax 22.50

SEE ATTACHED

(Permanent Index Number: 24-28-15-100-002)

- SUBJECT TO:
- (1) Real estate taxes for the year 2002 and subsequent years;
 - (2) Covenants, conditions, restrictions and easements apparent or of record;
 - (3) All applicable zoning laws and ordinances;

situated in the County of Champaign and State of Illinois hereby releasing and waiving all rights under and by virtue of the Homestead Exemption Laws of the State of Illinois.

Dated this 20 day of January, 2003.

Sport Redi-Mix, LLC,
an Illinois Limited Liability Company

By: [Signature]
Michael Ducey, authorized Manager

STATE OF ILLINOIS)
) SS.
COUNTY OF CHAMPAIGN)

I, the undersigned, a Notary Public in and for said County and State aforesaid, DO HEREBY CERTIFY that Michael Ducey, personally known to me to be the authorized manager of Sport Redi-Mix, LLC, an Illinois Limited Liability

Company, the same person whose name is subscribed to the foregoing instrument, appeared before me this day in person and acknowledged that he signed, sealed and delivered the said instrument as his free and voluntary act, for the uses and purposes therein set forth, including the waiver of the right of homestead.

Given under my hand and Notarial Seal this 28th day of January, 2003.

OFFICIAL SEAL
KEVIN J HENDERSON
NOTARY PUBLIC, STATE OF ILLINOIS
MY COMMISSION EXPIRES: 05/11/08
[Signature]
NOTARY PUBLIC

005028

Deed Prepared by:
RICHARD C. KIRBY
ERWIN, MARTINKUS & COLE
411 WEST UNIVERSITY
CHAMPAIGN, IL 61820

Send Tax Bill To:/Return To:
William Bryant
1010 CR ~~1800~~ 2125E
Sidney, IL 61877

Exempt under the provisions of Paragraph __, Section 4, Real Estate Transfer Tax Act.

Date _____ Signature _____
Buyer, Seller, or Representative

005028

Tract 1:

Part of the Northeast Quarter of the Northwest Quarter of Section 15, Township 18 North, Range 10 East of the Third Principal Meridian, situated in Champaign County, Illinois, described as follows:

Beginning at the intersection of the South right of way line of State Aid Route 15 and the East line of the East Half of the Northwest Quarter of Section 15, Township 18 North, Range 10 East of the Third Principal Meridian; thence Southerly, on said East line and on the West right of way line of The Chicago and Eastern Illinois Railroad, 21.15 feet; thence Southwesterly 135.7 feet on said West right of way line to the North right of way line of The Norfolk and Western Railway Co.; thence Westerly 750.0 feet on said North right of way line; thence Northerly 292.0 feet perpendicular to said North right of way line to the South right of way line of State Aid Route 15; thence Southeasterly on said right of way line 352.3 feet to a concrete right of way marker; thence Southeasterly 149.8 feet to a concrete right of way marker, thence Southeasterly 329.1 feet to the point of beginning, as per Plat of Survey by Chandler S. Parsons, Illinois Land Surveyor, dated June 5, 1966.

Tract 2:

Part of the Northeast Quarter of the Northwest Quarter of Section 15, Township 18 North, Range 10 East of the Third Principal Meridian, situated in Champaign County, Illinois, described as follows:

Beginning at the Northeast Corner of said Northwest Quarter of said Section 15, thence South $00^{\circ}30'47''$ East, along the East line of said Northwest Quarter of Section 15 a distance of 63.47 feet to an iron rod situated on the South right of way line of State Aid Route 15, as said right of way line is described by document no. 748054 in the office of the Champaign County Recorder; thence North $87^{\circ}82'14''$ West, along said South right of way line a distance of 318.09 feet to a concrete right of way marker; thence North $87^{\circ}52'14''$ West, along said South right of way line, a distance of 150.10 feet to a concrete right of way marker; thence North $88^{\circ}29'28''$ West, along said South right of way line, a distance of 351.19 feet to an iron rod, thence due South to the North line of said Section 15, thence North $89^{\circ}41'11''$ East along the North line to the point of beginning.

005028

PLAT ACT AFFIDAVIT

STATE OF ILLINOIS)
) SS.
COUNTY OF CHAMPAIGN)

RICHARD C. KIRBY, being duly sworn on oath, states that he resides at 411 W. University Ave., Champaign, IL 61820 and that the attached deed is not in violation of Section 1 of Chapter 109 of the Illinois Revised Statutes for one of the following reasons:

1. Said Act is not applicable as the Grantors own no property adjoining the premises described in said deed (existing property)

OR

the conveyance falls in one of the following exemptions permitted by the Amended Act which became effective July 17, 1959.

2. The division or subdivision of land into parcels or tracts of five (5) acres or more in size which does not involve any new streets or easements of access.

3. The division of lots or blocks of less than one (1) acres in any recorded subdivision which does not involve any new streets or easements of access.

4. The sale or exchange of parcels of land between owners of adjoining and contiguous land.

5. The conveyance of parcels of land or interests therein for use as right of way for railroads or other public utility facilities, which does not involve any new streets or assessments of access.

6. The conveyance of land owned by railroad or other public utility which does not involve any new streets or easements of access.

7. The conveyance of land for highway or other public purposes or grants or conveyances relating to the dedication of land for public use or instruments relating to the vacation of land impressed with a public use.

8. Conveyances made to correct descriptions in prior conveyances.

9. The sale or exchange of parcels or tracts of land existing on July 17, 1959 into no more than two (2) parts and not involving any new streets or easements of access.



005028

10. The sale of a single lot of less than five (5) acres from a larger tract when a survey is made by a registered surveyor; provided, however, that this exemption shall not apply to the sale of any subsequent lots from the same larger tract of land, as determined by the dimensions and configuration of the larger tract on October 1, 1973.

CIRCLE NUMBER ABOVE WHICH IS APPLICABLE TO ATTACHED DEED

AFFIANT further states that he makes this affidavit for the purposes of inducing the Recorder of Deeds of Champaign County Illinois, to accept the attached deed for recording.

To the best of Affiant knowledge and belief, the attached deed does not violate the Subdivision Ordinance of any municipality.

Richard C. Kirby

SUBSCRIBED and SWORN to before me
this 28 day of January, 2003.

NOTARY PUBLIC



RECEIVED
CLERK'S OFFICE

APR - 5 2012

STATE OF ILLINOIS
Pollution Control Board

PROOF OF SERVICE

I hereby certify that I did on the 3rd day of April 2012, send by Certified Mail, Return Receipt Requested, with postage thereon fully prepaid, by depositing in a United States Post Office Box a true and correct copy of the following instrument(s) entitled ADMINISTRATIVE CITATION, AFFIDAVIT, and OPEN DUMP INSPECTION CHECKLIST

To: William Bryant
1010 County Road, 2125 E
Sidney, IL 61877-9752

and the original and nine (9) true and correct copies of the same foregoing instruments on the same date by Certified Mail, Return Receipt Requested, with postage thereon fully prepaid

To: John Therriault, Clerk
Pollution Control Board
James R. Thompson Center
100 West Randolph Street, Suite 11-500
Chicago, Illinois 60601

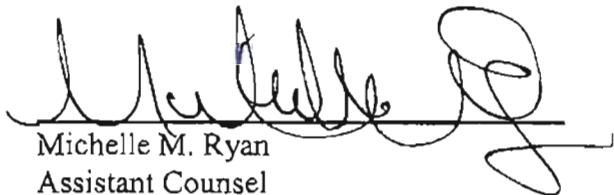

Michelle M. Ryan
Assistant Counsel

Illinois Environmental Protection Agency
1021 North Grand Avenue East
P.O. Box 19276
Springfield, Illinois 62794-9276
(217) 782-5544